

# THE BULLETIN

701  
BSD

*of Beth Sholom Congregation  
Frederick, Maryland*

December 2010

Volume XII, Issue 6

Kislev/Tevet 5771

New Date!



**SAVE THE DATE!!!!**  
Beth Sholom Congregation  
Casino Night



Saturday, February 19, 2011  
7:30 P.M.

Tickets  
\$40 in advance / \$50 at the Door



## The President's Corner

by Gayle Bromberg  
gaylebromberg@yahoo.com



As I'm getting ready for Chanukah, while looking for recipes for other kinds of latkes besides the traditional potato, I am also thinking a lot about the meaning of the Chanukah lights. We all know the the eight candles represent the miracle of the small vial of oil lasting eight days, until a new supply of pure oil could be obtained to light the menorah in the Beit Hamikdash, when the Assyrians, who had conquered and Hellenized the Temple, were forced out. On another level, the miracle was that a small group Jews, under Judah the Maccabee, were able to oust the Assyrian army. There are many other layers of Rabbinic and scholarly interpretations of the miracle. Chanukah is also one of those few holidays that is celebrated at home, with our families and friends. So I think about the Chanukah lights in personal and family-related terms.

These are some of my associations. When I was a young child, a rabbi explained that a single, small light could illuminate a whole room. I remember that for me as a young girl, the realization of that fact was like a miracle. The message was that a small child, a frail elderly person, or any small deed could make a huge

(Continued on page 9)

## Chanukah Candlelighting Schedule

	Wed., Dec. 1, after nightfall, Blessings 1, 2 & 3
	Thurs., Dec. 2, after nightfall Blessings 1 & 2
	Fri., Dec. 3, before Shabbat candlelighting, Blessings 1 & 2
	Sat., Dec. 4, after Shabbat ends Blessings 1 & 2
	Sun., Dec. 5, after nightfall Blessings 1 & 2
	Mon., Dec. 6, after nightfall Blessings 1 & 2
	Tues., Dec. 7, after nightfall Blessings 1 & 2
	Wed., Dec. 8, after nightfall, Blessings 1 & 2

### Candlelighting Blessings

*Before kindling the menorah lights, recite:*

1. Baruch Atah Hashem Elokeinu Melech Ha-olam Asher Kideshanu Bemitzvosav Vetzivanu Lehadlik Ner Shel Chanukah. Blessed are you, Lord our G-d, King of the universe, who has sanctified us by His commandments, and has commanded us to kindle the lights of Chanukah.

2. Baruch Atah Hashem Elokeinu Melech Ha-olam She-asa Nisim La-avoseinu bayamim Haheim Bazman Hazeh. Blessed are you, Lord our G-d, King of the universe, who wrought miracles for our father in days of old, at this season.

*The following blessing is said only on the first evening (or the first time one kindles the lights this Chanukah):*

3. Baruch Atah Hashem Elokeinu Melech Ha-olam Shehecheyanu Vekiyemanu Vehigianu Lazman Hazeh. Blessed are you, Lord our G-d, King of the universe, who has kept us alive, and has preserved us, and enabled us to reach this season.

### EXCITING OPPORTUNITY!

With the introduction of the Triennial Torah Reading cycle, it is now possible for many more people to read, or learn to read from the Torah! You may read as little or as much as you wish, since a different reader may be used for each aliyah, and as many times throughout the year as you wish. Some aliyot contain as few as three sentences. **WE WILL TRAIN YOU!** Come discover what reading Torah can do for you: enhance your personal spiritual connection, understand the Torah on a deeper level, participate in making our Beth Sholom services special. Please email Richard Haber: [rhaber@frederickcountymd.gov](mailto:rhaber@frederickcountymd.gov). to tell him you are interested! Thank you. ✨

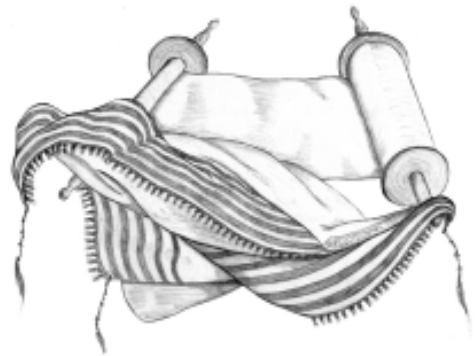

Join us for  
Shabbat.



Please join us with your friends and family on  
Friday, December 3, 2010, at 6:30 p.m.  
for a Shabbat service and community dinner.  
We will celebrate Chanukah!

Cost: \$12 per adult  
\$8 per child age 3-12  
Family maximum \$48



Call to check on availability, 301-663-3437.

*Beth Sholom  
Religious School*



Pauline Horn, Director

Mrs. Peltz's Kindergarten class recently held a Food Drive for the Frederick Food Bank. (See photo.) They had been introduced to the concept of feeding the hungry through a process of discovery about what they can do to be "good people." In addition to discovering Mitzvot, the children are also learning about Bible characters in Genesis, the history of and preparations for Fall Holidays, and the Synagogue, which is their favorite, since they get to go on "walking field trips" through the sanctuary, to experience first-hand the many objects and rituals they are studying! ☆



**On behalf of the board of  
Beth Sholom Sisterhood,  
I would like to wish everyone  
a Happy Chanukah and  
happy holiday season,  
and thank you for your  
continuing support.**

**Carol Blum, President**



**Are you planning a Simcha?**

Did you know that you can order Bar & Bat Mitzvah invitations, wedding invitations and other items from Beth Sholom at a substantial **discount?**

We have several beautiful books to choose from; come in and take a look!



**SPECIAL ANNIVERSARIES**  
Susan & Boyd Dwyer

**SPECIAL BIRTHDAYS**  
Elise Mekelburg  
Jerry Reed



## The Story of Chanukah



Every year between the end of November and the end of December, Jewish people around the world celebrate the holiday of Chanukah, the Festival of Lights. Chanukah begins on the 25th day of the Hebrew month of Kislev, but the starting date on the western calendar varies from year to year. The holiday celebrates the events which took place over 2,300 years ago in the land of Judea, which is now Israel.

Long ago in the land of Judea there was a Syrian king, Antiochus. The king ordered the Jewish people to reject their G-d, their religion, their customs and their beliefs and to worship the Greek gods. There were some who did as they were told, but many refused. One who refused was Judah Maccabee.

Judah and his four brothers formed an army and chose as their name the word "Maccabee", which means hammer. After three years of fighting, the Maccabees were finally successful in driving the Syrians out of Israel and reclaimed the Temple in Jerusalem. The Maccabees wanted to clean the building and to remove the hated Greek symbols and statues. On the 25th day of the month of Kislev, the job was finished and the temple was rededicated.

When Judah and his followers finished cleaning the temple, they wanted to light the eternal light, known as the N'er Tamid, which is present in every Jewish house of worship. Once lit, the oil lamp should never be extinguished.

Only a tiny jug of oil was found with only enough for a single day. The oil lamp was filled and lit. Then a miracle occurred as the tiny amount of oil stayed lit not for one day, but for eight days.

Jews celebrate Chanukah to mark the victory over the Syrians and the rededication of the Jerusalem Temple. The Festival of the Lights, Chanukah, lasts for eight days to commemorate the miracle of the oil. The word Chanukah means "rededication".

In America, families celebrate Chanukah at home. They give and receive gifts, decorate the house, entertain friends and family, eat special foods, and light the holiday menorah. ✡

## How to Play Dreidel

The Hebrew word for dreidel is Sevivon, which means "to turn around." Dreidels have four Hebrew letters on them, and they stand for the saying, "Nes Gadol Haya Sham," meaning "a great miracle happened there." In Israel, the saying is, "Nes Gadol Haya Po," "a great miracle happened here."

According to some historians, Jews first played with a spinning top during the rule of the Greek King Antiochus. In Judea, Antiochus had outlawed Jewish worship, so the Jews would use a game with the spinning top as a ruse to conceal that they were secretly studying Torah.

Playing with the dreidel is a traditional Chanukah game played in Jewish homes all over the world. Here's how to play the basic dreidel game:

1. Any number of people can take part in this great game.
2. Each player begins the game with an equal number of game pieces (about 10-15) such as pennies, nuts, raisins, etc.
3. At the beginning of each round, every participant puts one game piece into the center "pot." In addition, every time the pot is empty or has only one game piece left, every player should put one in the pot.
4. When it's your turn, spin the dreidel once. Depending on the outcome, you give or get game pieces from the pot:
  - a. *Nun* means "nisht" or "nothing" in Yiddish. The player does nothing.
  - b. *Gimmel* means "gantz" or "everything" in Yiddish. The player gets the whole pot.
  - c. *Hey* means "halb" or "half" in Yiddish. The player gets half of the pot. (If there is an odd number of pieces in the pot, the player takes half plus one.)
  - d. *Shin* (outside of Israel) means "shtel" or "put in" in Yiddish. *Peh* (in Israel) means "pay." The player adds a game piece to the pot.
5. If you have no game pieces left, you are either "out" or may ask a fellow player for a "loan."
6. When one person has won everything, the round is over!



The four sides of the dreidel,  
from right: *nun*, *gimmel*, *hey* and *shin*



National Council of Jewish Women  
Frederick Section

**A FAITH IN THE FUTURE  
A BELIEF IN ACTION**

**by Marcy Taylor, President**

It is such a wonderful feeling to experience first hand the generosity of our community. We delivered an SUV packed full of gifts to Baltimore for our Dreidel Adopt-a-Family. As we unloaded the gifts, we heard repeatedly how much NCJW Frederick Section's generosity and support is appreciated each year. Thank you to all that supported this family!

We will be collecting for the Snowflake family until Sunday, Dec. 14 and there are still some Snowflakes remaining. We will be having a gift-wrapping "Mitzvot and Merlot" evening at my home on December 16 to wrap the Snowflake family gifts; please contact me (301-694-8212) if you would like more information regarding this event.

Members from Beth Sholom Sisterhood, Hadassah, Kol Ami and NCJW attended the first planning session for our Women's Seder, scheduled for April 14. Mark your calendars now for what is promising to be a remarkable event!

Our next general meeting will be at Beth Sholom on Tuesday, Dec. 7 at 7 p.m.

Wishing you and your families every happiness at Chanukah and throughout the holiday season!

For more information on NCJW Frederick Section, please check out our web site [www.ncjwfrederick.org](http://www.ncjwfrederick.org) or contact any NCJW Board Member. ☆



**Harvey Levy, D.M.D., M.A.G.D.**  
**David M. Somerville, D.D.S., F.A.G.D.**  
**Niraj D. Patel, D.M.D., F.A.G.D.**  
**Sunanda Bhushan, D.M.D.**

198 Thomas Johnson Dr., Suite 108  
 Frederick, Maryland 21702  
 (301) 663-8300 (Voice or TDD)  
[www.DrHLevyAssoc.com](http://www.DrHLevyAssoc.com)  
[DrHLevy@gmail.com](mailto:DrHLevy@gmail.com)

**DENTISTRY FOR CHILDREN AND ADULTS**  
 Including Sedation In The Office,  
 And Dentistry While You Sleep At Frederick Memorial Hospital

**Beth Sholom  
Early Childhood Center**

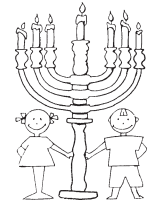

**Two's News**

By Heidi Sadoughi, teacher  
two-year-olds

Although you might think "school" and "two-year-olds" are terms that rarely mingle, our two-year-olds have done a marvelous job transitioning to their new routine of going to school! School at this age is less about worksheets and lessons, and more about becoming part of a group. The children are introduced to sharing and taking turns, making friends, and developing their speech. Socialization is also a huge part of their school day. Sometimes a hug accidentally becomes a push and tears erupt. It's all part of a normal day with our two-year olds.

No, your child won't be reading or penning his/her name because of this early education experience! But coloring and painting will help to strengthen muscles that will later be used to write. Exposure to printed material will help them prepare for reading. And it's not just books; two's love to see their own names written down, such as when we put them on pictures they draw. By the end of the year our children have gotten a head start on their educational success in a nurturing atmosphere. ☆

**Congratulations**  
to

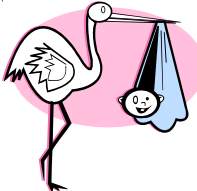

Karen & Joe Ashwal  
on the birth of their grandson,  
**Levi Aaron Ashwal**  
son of Lindsay & Andy Ashwal

and

Sylvia Sclar  
on the birth of her great grandchildren  
**Morgan Zachary Nelson**  
and  
**Alexa Edith Nelson**  
November 3, 2010  
Morgan and Alexa are the grandchildren of  
Ellen (Sclar) and Frank Nelson

## The Beth Sholom

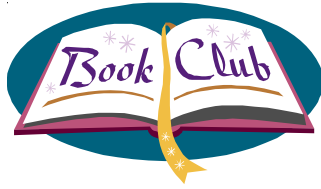

The next Beth Sholom Book Club selection will be **“Beautiful as the Moon; Radiant as the Stars: Jewish Women in Yiddish Stories, An Anthology,”** a collection of short stories translated from Yiddish edited by Sandra Bark. One review/summary states:

“Bark’s appealing anthology gathers 22 stories chronicling Jewish women’s lives in late 19th- and early 20th-century Europe, Russia, the United States and Israel. Though most of the stories were published in the 1920s and ’30s, many in Yiddish newspapers and magazines, their themes—love, thwarted ambition, identity, assimilation—still resonate. The heroines, who are of all ages and classes, find themselves struggling for education, autonomy, equality—just as many of their real-life contemporaries did.” No need to read the whole collection of stories, though it’s really a quick and delightful read, cover to cover! And men will find it just as enjoyable as women have.

Due to conflicts with our scheduled bi-monthly, fourth Sunday meeting in December, we will meet at Beth Sholom Community Center on January 23, time TBA. A notice will come out in January with more specifics and a proposed list of future picks.



Questions? Contact Carolyn Snyder at 301-631-3991 or [csnyder239@comcast.net](mailto:csnyder239@comcast.net). ☆

### Beth Sholom Congregation

1011 N. Market Street • Frederick, MD 21701  
301-663-3437 • 301-663-8154 (fax)  
[bethsholomfrederick@yahoo.com](mailto:bethsholomfrederick@yahoo.com)  
[www.bethsholomfrederick.org](http://www.bethsholomfrederick.org)

Murray Singerman, Rabbi / [rabbisingerman@gmail.com](mailto:rabbisingerman@gmail.com)

Morris Kosman, Rabbi Emeritus / [mkosman@aol.com](mailto:mkosman@aol.com)

Gayle Bromberg, President / [gaylebromberg@yahoo.com](mailto:gaylebromberg@yahoo.com)

Pauline Horn, Executive Director / [phshulbiz@yahoo.com](mailto:phshulbiz@yahoo.com)

Janet Potash, Administrative Assistant  
*Bulletin* Editor

[bethsholomfrederick@yahoo.com](mailto:bethsholomfrederick@yahoo.com)

### Teen☆Volunteer☆Corps

by Kevin Dwyer

Teen Volunteer Corps has gotten started for this year. We have been invited to join USY and all youth programs at Shaare Torah Congregation again this year. Please contact Pauline Horn for USY registration information.

Many of the teens participated in Mitzvah Day in October. Also in October, Barbara Fromer met with us to talk about “getting into college.” We are planning a Family Movie Night on Jan. 15 from 6 to 8 p.m. We hope to show *Monsters Inc.* and offer babysitting. Watch for more information about this event. If you would like to join us, please email [susandwy@gmail.com](mailto:susandwy@gmail.com) to join our email group. ☆

### Membership News

by Susan Dwyer, Chair  
Membership Committee



This month Beth Sholom kept the members busy with many programs. Hopefully, many of you participated in Mitzvah Day! If you did, you may have met this month’s featured members—the Abrams family.

Joan and Mitchell Abrams, with 13-

year-old Jenna and 11-year-old Adam are new members. They moved to Frederick in 2009 from the Philadelphia area. Joan is a Jersey girl, while Mitchell is Brooklyn born. Joan is working in the pharmaceutical industry, while Mitchell is in IT and finance. They had both been very active in their last Conservative Congregation as Sunday School teachers, through Board Membership, and as Committee chair people. Mitchell was also active in his former Synagogue’s choir, and has recently been seen with his guitar at Beth Sholom. The Abrams are definitely a family who believe that every day is a day for Mitzvot. Please make sure to look for them and join them in activities at Beth Sholom! Welcome Abrams Family and all our new members! ☆



**Beth Sholom  
Congregation  
&  
Shoresh  
present**



Not your Bubbie's  
**Chanukah Party**  
**Sunday, December 5th**  
**10:00 AM-12:00 PM**  
**at Beth Sholom Community Center**  
**\$3/child**



**RSVP**  
**to Beth Sholom**  
**(301) 663-3437**  
**[bethsholomfrederick@yahoo.com](mailto:bethsholomfrederick@yahoo.com)**  
**or**  
**to Shoresh**  
**(410) 358-8571**  
**[shoresh@shoresh.com](mailto:shoresh@shoresh.com)**



**Baltimore Ravens visit Camp Shoresh!**

# DATES

## camp shoresh 2011

Meet, Greet, & Eat: Sunday, June 12, 2011  
 FIRST SESSION: Monday, June 27 – Saturday Night, July 16, 2011  
 SECOND SESSION: Monday, July 18 – Saturday Night, August 6, 2011  
 Closing Ceremonies: Sunday, August 7, 2011 – 2:00-3:30  
 NO CAMP: Monday, July 4 (Tisha B'Av)  
 Friday, July 15 (Frederick Shabbaton)  
 There will be camp for Little & Junior Shoresh on July 15th

## special events

For Grades 2–10  
 Thursday, June 30: Hershey Park  
 Wednesday, July 6: Late Stay Concert,  
 Boys Overnight, CIT Trip, & Picture Day  
 Fri. Night – Sat. Night, July 8-9: CIT Shabbaton in Baltimore  
 Monday, July 11: Little & Junior Shoresh Trip  
 Tuesday, July 12: Girls Overnight  
 Fri. Night – Sat. Night, July 15-16: Frederick Shabbaton  
 Thursday, July 21: Kings Dominion  
 Tuesday, July 26: Little & Junior Shoresh Trip  
 Wednesday, July 27: CIT Trip  
 Friday – Sat. Night, August 5-6: Baltimore Shabbaton

# FEES

Junior Shoresh: \$735/session 1 - \$735/session 2  
 (Early-bird by 1/17/11\*: \$50 off per session)  
 Shoresh: \$865/session 1 - \$865/session 2  
 (Early-bird by 1/17/11\*: \$50 off per session)  
 C.I.T. Program: \$965/session 1 - \$965/session 2  
 (Early-bird by 1/17/11\*: \$50 off per session)  
 \*Early Bird applies to the first 75 families  
 Transportation: \$210/session 1 - \$210/session 2  
 Frederick Transportation: \$75 session 1/ \$75 session 2  
 Sibling Discount: First child pays full tuition; each additional child receives \$35 off per session



For questions, please contact the Shoresh office at:  
 (410) 358-8571  
 Email: shoresh@shoresh.com  
[www.Shoresh.com](http://www.Shoresh.com)

(Cont. from page 1)

difference. Love or hatred can also spread out and fill a large space. It was also a message about how G-d's love and presence is manifested in our lives.

Forty years ago, when my very sweet, loving, wise, hardworking grandmother passed away, an older cousin comforted me by telling me that my grandmother was like the shamash, lighting all the other candles, and that we, her children and grandchildren, were the other candles, carrying on her light. I have continued to believe, over the years, that her kind words are true, and have been inspired by them to try to carry forth my grandmother's wisdom, lovingkindness, and dedication. I also learned to think about people as lights in the world. When people bring love, happiness, and wisdom into my life, or into the world, I think of them as lights. I thought about that metaphor a lot during the two weekends when we had three b'nai mitzvah—Juliana Lynch, Max Cantor, and Adi Singerman. Each of the young people were their own unique selves, each reflected the specialness of their own families, and their events each had some special quality. They each brought light to our synagogue community, and because they happened close together, they brought what felt like a season of light. A further reflection on this theme is that, although one light can fill a room, we light eight candles plus the shamash. This serves as a reminder that our light is



sparked by the much greater light of Hashem, and that when we stand together and share our light with each other, we have a light that is brighter, stronger, and continually being sparked.

Ultimately, it seems to me that when we keep Judaism alive in our families and communities; when we keep alive the memories of our relatives and ancestors; when we do acts of lovingkindness, charity, tikkun olam, or other mitzvot; we are the lights—we are the miracle. I hope you all have a de-light-ful Chanukah, and that you will come to celebrate with your friends at the Beth Sholom/Shoresh Chanukah party on December 5.

Shalom,  
Gayle Bromberg, President



# The Jewish Home: Finding Judaism in Every Room of the House

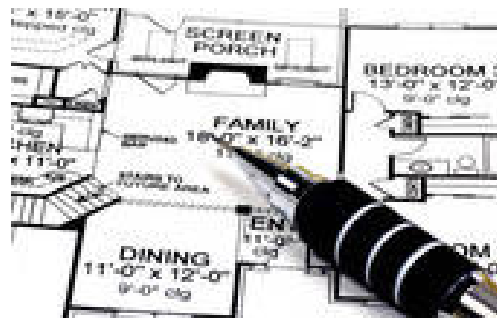

- ~~Part #1~~ — Wednesday, October 20th — ~~KITCHEN - KOSHER KURRICULUM~~ — (completed)
- ~~Part #2~~ — Wednesday, November 17th — ~~DINING ROOM - SHABBOS~~ — (completed)
- Part #3** — Wednesday, December 15th — **BEDROOM - FAMILY PURITY**

All classes will be taught by Rabbi T  
and will take place at 7:30 PM at Beth Sholom Community Center  
There is NO charge for these classes

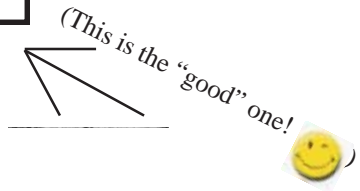

## Mitzvah Day by Stacey Springer

*"I've learned that people will forget what you said, people will forget what you did,  
but people will never forget how you made them feel". - Maya Angelou*

On October 17, 2010, the Shapiro G'Mach/Chesed Committee sponsored Beth Sholom's first congregation-wide Mitzvah Day. It was a tremendous success.

We had over 50 participants who volunteered their time with abandoned animals at Days End Farm Horse Rescue, Inc., cheered up residents with an ice cream social at Northampton Manor Health Care, and honored heroes who make us safe—our firemen. Decorated cupcakes were delivered to the following firehouses: Spring Ridge Fire Station, Westview Fire Station, Carroll Manor, New Market District Volunteer Fire Co., Citizens Truck Co., United Steam Fire Engine Co., Junior Fire Co. and Independent Hose Co. In addition, children and families created cards that will be used for many different occasions—get well, thank you, happy birthday and thinking of you. Many of our Beth Sholom congregants participated, along with Hebrew school and Early Childhood Center students, parents and teachers.

Two activities were ongoing until November 17, 2010. The Winter Coat Drive provided more than 25 adult coats to the Cold Weather Shelter and another 25 children's coats to the Frederick County Department of Social Services. The sale of special custom-made blankets, created by Andrea Eyler, has raised funds for the G'Mach/Chesed Committee, and we will make a donation to the Frederick Memorial Cancer Center Patient Fund. This fund provides financial assistance to cancer patients who are receiving treatment and need assistance with bills, food, childcare needs, etc.

Mitzvah Day was a collaborative effort to promote the importance of giving back to our community by helping those in need, whether the assistance is financial, or simply lending a helping hand or providing a special smile or the comfort of having caring visitors. If you participated in this special endeavor and have not received your Certificate of Appreciation, please contact Stacey Springer at: [springerkids@comcast.net](mailto:springerkids@comcast.net) ☆



*Mitzvah Day activities, clockwise from bottom left: making cupcakes for the firemen, Northampton ice cream social, making cards, more cupcakes, even more cupcakes!*

**Yahrzeits**  
**Kislev/Tevet 5771**  
**December 2010**



December 3\*

Herman Sheppard  
Stanley Brandorff  
Eric Pickert  
Charles Glick  
Lenore Stern  
Louise Zweig  
Ida Aal

Isadore Brandt  
Alexander B. Lazerowitz  
Charles Mogilewsky  
Eva Chernoff Buchenbaum  
Minnie Pollicove  
Devera Silverman

December 10\*

Jacob Horowitz  
Karl Jacobson  
Samuel Kalb  
Joseph Hochhauser  
John Warren  
Rose Bernstein Jacobs  
Neil Fromer

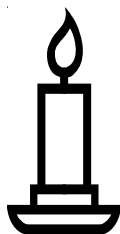

December 17\*

Alvin Blumenstein  
Leo Friedman  
Sam Needle  
Bea Greenfield  
Egon Gartenberg  
Morris Mandelowitz

Esther Spielman  
Harry Warendorf, Jr.  
Sarah Davis  
Goldie Hochhauser  
William Simbaliski  
Alec Meyer

December 24\*

Harriet Goldstein  
Anna Isaac  
Marion Kandel  
Adele Filderman  
Irwin Fishman  
Isaac Macarthy

Samuel Snyder  
Leib Aryeh Frisher  
Celia Pearl Smith  
Sadie Fleisher  
Bernice Markowitz  
Celeste Warendorf

December 31\*

Fannie Piasetzky  
Goldie Stein  
Bess Wolfson  
Charles Pearlman

Minnie Stern  
H. Michael Blum  
Samuel Solomon Brown  
Michael Halper

**DONATIONS**



Beth Sholom gratefully acknowledges the following donations:

**Aliyahs and Honors**

Joe Brotman

**Building Fund**

Shana Potash for the Yahrzeits of Albert Potash and Samuel Potash

Shirley Miller for the Yahrzeits of Saul Miller and Martin Miller

Shana Potash in honor of Janis Sclar's special birthday

Shirley Miller in memory of Harvey Botkin

**Early Childhood Center**

Evelyn Brandorff for the Yahrzeit of Stanley Brandorff

Shirley Neufeld in honor of Janis Sclar's special birthday

Shirley Neufeld for the speedy recovery of Leah Reitman

Joyce & Milt Gordon for the speedy recovery of Marion Zebovitz

Marlene Sclar in honor of the birth of Morgan Zachary and Alexa Edith Nelson

Janis Sclar in honor of the birth of Morgan Zachary and Alexa Edith Nelson

**Education Fund**

Marcy Taylor in honor of the birth of Levi Aaron Ashwal

**General Fund**

Roz Nasher for the Yahrzeits of Morris & Rebecca Linzner

Marcia & Peter Newfeld for the Yahrzeit of Robert Pittle

Leah & Morty Reitman for the Yahrzeits of Bernard Mlavsky and Elizabeth Reitman

Marion & Euene Zebovitz for the Yahrzeit of Charles Mogilewsky

Kim & Tony DiGiorgio & family for the Yahrzeit of Lillian Epstein

Carol & Rabbi Kosman for the Yahrzeit of Louis Kosman  
Marianne & Marty Erlichman for the Yahrzeit of Saul Kochonin

Eileen Ebert & Bruce Zavos for the Yahrzeit of Bernard Zavos

Martha & Martin Zweig for the Yahrzeits of Louise Zweig and George Rosen

Sylvia Sclar for the Yahrzeit of Stanley Brandorff

Daniel Blank for the Yahrzeit of Herman Blank

Roz Nasher in memory of Pearle Carpel

Janis Sclar in memory of Jules Sherr

Rita & Paul Gordon in honor of Janis Sclar's special birthday

\* indicates Friday on which name will be read from the Bima.

*Beth Sholom extends sincere condolences  
to*

*Marshall and Sharon Botkin and  
family on the passing of Marshall's  
father, Harvey Botkin*



#### **DONATIONS**

##### **General Fund (Cont.)**

Rita & Paul Gordon in honor of the birth of Morgan Zachary and Alexa Edith Nelson  
Rita & Paul Gordon in honor of the birth of Levi Aaron Ashwal  
Ricki & Denny Deragisch in honor of Janis Sclar's special birthday  
Regina Kaiktsian in honor of Selma Blum and family  
Karen & Joe Ashwal in honor of Adi Singerman's Bat Mitzvah  
Ellen & Ken Berkowitz in honor of Adi Singerman's Bat Mitzvah  
Marion & Eugene Zebovitz in honor of the birth of Levi Aaron Ashwal  
Judy & Earl Nelson for the speedy recovery of Marion Zebovitz  
Judy & Earl Nelson in honor of Adi Singerman's Bat Mitzvah  
Judy & Earl Nelson in honor of Max Cantor's Bar Mitzvah  
Leah & Morty Reitman for the Yahrzeit of Harry Reitman  
Betsy Nicholas & Paul Kessler in honor of the birth of Levi Aaron Ashwal  
Chris & Mike Eissenstat in honor of the birth of Levi Aaron Ashwal  
Bessie Pollicove for the Yahrzeits of Eva Chernoff Buchenbaum and Minnie Pollicove

##### **General Fund in Memory of Harvey Botkin**

Marion & Eugene Zebovitz  
Norman K. Ross  
Bobbi & Woods Price  
Ellen & Ken Berkowitz  
Karen & Joe Ashwal  
Judy & Roger Wolf  
Naomi & Carl Lazerow  
Judy & Earl Nelson

Junior Fire Company  
Bettie & George Delaplaine  
Cindi & Barry Diamondstone  
Charlotte Gottlieb  
Shelly & Arthur Horn  
Nancy Caplan  
Betsy Nicholas & Paul Kessler

##### **High Holy Day Appeal**

Marcia & Peter Newfeld

##### **Paul & Rita Gordon Music Education Fund**

Rita & Paul Gordon in memory of Harvey Botkin

##### **Shapiro G'Mach/Chesed Fund**

Carolyn Snyder & Jim Lewin for the Yahrzeit of Joseph Lewin  
Susan & Boyd Dwyer in memory of Harvey Botkin

##### **Prayer Book Fund**

Alison & Jack Lynch in memory of Joyce Kimmelman

##### **Programming Fund**

Norma & Morrie Kelsey in memory of Harvey Botkin

##### **Torah Fund**

Myra & Glenn Treiber in memory of Harvey Botkin ☆

Cemetery plot available  
Resthaven Memorial Gardens  
Garden of Solomon

Call Richard Kaufman  
at 770-685-1055.

The perfect setting for your special event!



Frederick - Ft. Detrick

Present this coupon and receive 10% off the rental fee for our elegant banquet hall. Seating and catering available for up to 120 people.

- Not valid with other offers -

Kosher menus available upon request.

Out of town guests? Ask for promotion code "BSC" for discounted guest room accommodations.

1565 Opossumtown Pike • Frederick, MD 21702  
Call Reba at (301) 696-1565

Who can number  
the sands of the sea,  
the drops of rain,  
and the days of eternity?  
- Ben Sira 1:2



The Garden of Solomon  
and  
Resthaven Funeral Services



Beautiful • Peaceful • Local

9501 Catoctin Mountain Highway  
U. S. Route 15 North  
Frederick, MD 21701

Cemetery 301-898-7177  
Funeral Home 301-898-1577

Call 24 hours a day  
for information



DAWN CRAMER STEIN

Certified Public Accountant



The CPA. Never Underestimate The Value.®

304 Delaware Road  
Frederick, MD 21701-4618  
dawn@dsteincpa.com

Tel: 301-663-8368  
Fax: 301-663-6786  
Cell: 301-964-3326



HEART FIELDS

Assisted Living & Alzheimer's Care at Frederick

1820 Latham Drive Frederick, Maryland 21701  
(301) 663-8800 • (301) 663-8801 Fax



A Five Star\* Quality Care Community

Stop in and celebrate  
with us - our 12 birthday -  
during the month of  
December!



Family and Cosmetic Dentistry

401 W. Seventh Street • Frederick, MD 21701  
Tel: 301.662.7766 • Fax: 301.662.7776  
www.friederdental.com  
drfrieder@yahoo.com



Office Hours By Appointment

**NEWMAN FAMILY CHIROPRACTIC  
DR. IAN NEWMAN**

198 Thomas Johnson Dr., #12  
Frederick, Maryland 21702  
(301) 696-8888, Fax: (301) 696-9618  
1190 Mount Aetna Road  
Hagerstown, MD 21740  
(301) 791-5900

*MJ Minton*  
ASSOCIATE BROKER, ECOBROKER®



**TURNING POINT**  
REAL ESTATE

*Residential and Commercial  
Sales and Rentals*

Special Training in Energy Efficiency  
Affecting Today's Real Estate Transaction



CELL 240.674.3374  
OFFICE 301.831.8232  
www.mjminton.net



**SUNSHINE MANAGEMENT  
CORPORATION**

**Nelson S. Zahler**

President  
Broker

Phone: (301) 663-8383 ext: 202  
Toll Free: 1-800-663-4990  
Fax: (301) 663-0070  
nelsonz@sunshinemanagement.net

Ambers Professional Center  
178 Thomas Johnson Drive, Ste. 201  
Frederick, MD 21702-4334  
www.sunshinemanagement.net



**Mark S. Hoffrichter, D.D.S.**  
Oral & Maxillofacial Surgery

**Mark S. Hoffrichter, DDS**

**Centerpark Medical Center**

604 Solarex Court, Suite 207  
Frederick, MD 21703  
301 695-5755

www.HoffrichterDDS.com



**David J. Levine, D.P.M., C. Ped.**

Podiatrist & Pedorthist  
www.Levinefeet.com

63 Thomas Johnson Drive  
Suite C  
Frederick, MD 21702

301-696-0818  
Fax 301-696-8872

PODIATRY • FOOT SURGERY • SPORTS MEDICINE



SEYMOUR B. STERN & ASSOCIATES, P.A.

**SEYMOUR B. STERN**  
ATTORNEY AT LAW

127 WEST PATRICK STREET  
FREDERICK, MARYLAND 21701

TEL: (301) 663-5335 x110  
FAX: (301) 663-8929  
E-MAIL: SSTERN@ST-LAW.COM



**Eye To Eye**

Family Eye Care

Tricare Network provider  
Ask about our Military Discounts

**Dr. Beverly Chado**  
**Dr. Steven Chado**  
*Optometrists*

2060 Yellow Springs Road, Frederick, Maryland 21702

**301.695.8771**

Across from gate on Yellow Springs Road in  
the Bloom Shopping Center

www.eyetoeyedr.com

# December 2010

24 Kislev 5771 - 24 Tevet 5771

Sunday	Monday	Tuesday	Wednesday	Thursday	Friday	Saturday
			1 24 KISLEV	2 25 KISLEV	3 26 KISLEV	4 27 KISLEV
				Chanukah - Day 1 8:30a Minyar 11a Brunch Bunc	Chanukah - Day 2 4:28 6:30p Service Shabbat Dinner	Chanukah - Day 3 Miketz 9:30a Service 10:30a Parents' Shabbat
5 28 KISLEV	6 29 KISLEV	7 30 KISLEV	8 1 TEVET	9 2 TEVET	10 3 TEVET	11 4 TEVET
Chanukah - Day 4 9:30a Minyar 9:30a Religious School 10a Beth Sholom Shores Chanukah Party Bingo	Chanukah - Day 5 Shoresh Bing	Chanukah - Day 6 Rosh Chodesh Tevet Day 1 7p NCJW Meeting	Chanukah - Day 7 Rosh Chodesh Tevet Day 2	Chanukah - Day 8 8:30a Minyar 11a Brunch Bunc	4:28 6:30p Service Shoresh Shabbat	Vayigash 9:30a Service Shoresh Shabbat
12 5 TEVET	13 6 TEVET	14 7 TEVET	15 8 TEVET	16 9 TEVET	17 10 TEVET	18 11 TEVET
9:30a Minyar 9:30a Religious School Bingo	10a Sisterhood Meeting Bingo		7p Board of Trustees Meeting 7:30p Shoresh Adult Class	8:30a Minyar 2 - 8p BLOOD DRIVE	Fast of the Tenth of Tevet 4:29 6:30p Service	Veyech 9:30a Service 6p ECC Havdalah Party
19 12 TEVET	20 13 TEVET	21 14 TEVET	22 15 TEVET	23 16 TEVET	24 17 TEVET	25 18 TEVET
9:30a Minyar 9:30a Religious School 9:30a Brunch and Learn Bingo	Shoresh Bing			8:30a Minyar 11a Brunch Bunc	4:32 6:30p Service NO SCHOOL	Christmas Day Shema 9:30a Service
26 19 TEVET	27 20 TEVET	28 21 TEVET	29 22 TEVET	30 23 TEVET	31 24 TEVET	
NO RELIGIOUS SCHOOL Bingo	NO SCHOOL Bingo	NO SCHOOL	NO SCHOOL	NO SCHOOL	4:37 6:30p Service No School	



**BETH SHOLOM CONGREGATION**  
**1011 North Market Street • Frederick, MD 21701**

Non-Profit Organization  
U. S. Postage  
**PAID**  
Frederick, MD  
21701  
Permit No. 162

## Table of Contents

Advertisements.....	3, 5, 12-14
Announcements and Special Events.....	1, 2, 7, 9, 10
Birthdays & Anniversaries.....	3
Book Club.....	6
Calendar.....	15
Condolences.....	12
Congratulations.....	5
Donations.....	11-12
Early Childhood Center.....	5
Membership.....	6
Mitzvah Day.....	10
NCJW.....	5
President's Corner.....	1
Religious Education.....	3
Shoresh.....	7,8, 9
Sisterhood.....	3
Special Events.....	1, 2, 10
Yahrzeits.....	11
Youth.....	6, 10