

THE BULLETIN

תשס"א
BSD

*of Beth Sholom Congregation
Frederick, Maryland*

November 2010

Volume XII, Issue 5

Cheshvan/Kislev 5771

New Date!



SAVE THE DATE!!!!
Beth Sholom Congregation
Casino Night

Saturday, February 19, 2011
7:30 P.M.

Tickets
\$40 in advance / \$50 at the Door



The President's Corner

by Gayle Bromberg
gaylebromberg@yahoo.com



A number of enjoyable and interesting events have been going on at Beth Sholom, some of them organized by our Program Committee, and some by Sisterhood, Hadassah, NCJW, our Rabbi, or Shoresh. These have given our Congregation a chance to socialize, meet and get better acquainted, make some new friends, learn, hike, take part in doing mitzvot, strengthen our positive relationship with the Frederick community, engage in Jewish learning, and raise needed funds for Beth Sholom and the other associated organizations mentioned above.

Rabbi Singerman has started meeting with our upcoming B'nai Mitzvot on Friday before Shabbat to study and prepare for their bar and bat mitzvah services. This has been a very positive experience for the teenagers, who are bonding with each

other, strengthening their Jewish identity and involvement in the synagogue. I've heard about at least one boy who has already committed to read a second Haftarah soon after his Bar Mitzvah. The Rabbi has also planned a hike combined with study of Maimonides ("Rambam on the Rocks"), in keeping with his dedication to helping us experience and live our Judaism outside the Synagogue.

In our Religious School, as well as through Shoresh, our students are enjoying learning with the aid of computers. Students have been encouraged to answer quiz game questions or compete in writing essays on a given subject, looking up the information on computers. The children who have signed up for the Israel Enrichment class are also having a great time learning in multidimensional ways — through cooking, music, art, computers. Adults have also enjoyed the learning opportunities at Beth Sholom, and many of you are probably aware that there are increased opportunities for learning and participation as we have changed to a triennial Torah reading. Shorter parshas mean that each segment of the reading is shorter and more manageable to

(continued on page 2)

President's Corner (cont.)

learn. Anyone with interest should contact Richard Haber. Rabbi Singerman and Richard are prepared and willing to help people learn. As someone who is new to reading Torah, I can share my experience and tell you that it brings me closer to the Torah, heightens my study, and is an amazing experience. I also love being able to participate in the communal experience, and contributing to the service. I hope more and more people will participate.

Here are some of the events and programs, sponsored by Beth Sholom and related organizations, going on this month: NCJW Holiday Portraits on Nov. 3 and 7, Hadassah cocktail party on Nov. 13, Education Committee Holiday Shopping Bazaar on Nov. 14, Sisterhood Purse Party on Nov. 21, NCJW's Adopt-a-Family program through Nov. 14 for the "Dreidel Family" and Dec. 14 for the "Snowflake Family." Please support these project in any way you can.

A special thanks to Stacey Springer for organizing and implementing the hugely successful Mitzvah Day. There is still time, until Nov. 17, to bring in coats of all sizes for their winter coat collection.

I hope everyone will read about all the upcoming events in the rest of this Bulletin, and avail yourselves of the opportunities to learn, participate, take a break from weekday stuff and experience Shabbat, add more fulfilling meaning to your lives, meet some wonderful people, and enjoy yourself with Beth Sholom. There are many opportunities here in our beautiful Community Center, out in the beauty of nature, or in one of our welcoming homes or offices at events sponsored by our associated organizations.

Shalom. ☆



SPECIAL ANNIVERSARIES
Linda and Andy Mekelburg

SPECIAL BIRTHDAYS
Marty Standel
Nelson Zahler





*Please join us at services
on Shabbat morning, November 6
when our son, Max
is called to the Torah
as a Bar Mitzvah*

Margie & Bobby Cantor

EXCITING OPPORTUNITY!

With the introduction of the Triennial Torah Reading cycle, it is now possible for many more people to read, or learn to read from the Torah! You may read as little or as much as you wish, since a different reader may be used for each aliyah, and as many times throughout the year as you wish. Some aliyot contain as few as three sentences. **WE WILL TRAIN YOU!** Come discover what reading Torah can do for you: enhance your personal spiritual connection, understand the Torah on a deeper level, participate in making our Beth Sholom services special. Please email Richard Haber: rhaber@frederickcountymd.gov. to tell him you are interested! Thank you. ☆

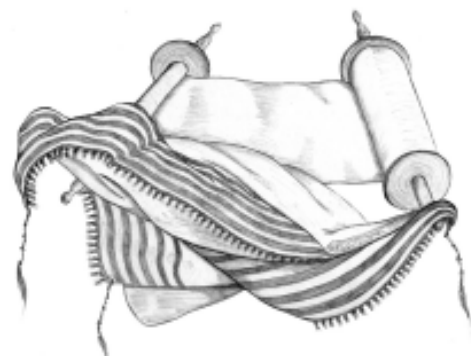

*Beth Sholom
Religious School*



Pauline Horn, Director



In the computer lab

The 2010-2011 school year is well under way. Our new curriculum is helping our teachers use their own creativity to provide experiential, informative and enjoyable lessons. We are particularly pleased to announce our new Computer Lab, thanks to the generosity, expertise and dedication of Ben and Shannon Icore. The lab is being used right now to supplement Hebrew instruction for our middle school students, and as a research tool (via the internet) for the teens. One of our classes has also begun a weekly blog, to keep friends and family apprised of what they are studying. Check it out:

<http://morahbatya.edublogs.org/> Comments are welcome.

We have embarked on a new program this year, for 3rd – 7th graders. It is an Israel Enrichment class, which meets weekly after Religious School. Under the direction of Morah Batya, they have created travel posters for cities in Israel, and acted as travel agents, making a pitch to their classmates to encourage them to travel to those locations, and have also made their own falafel. In the coming weeks, they will be participating in a Jerusalem webquest.

Watch future Bulletins for news about what other classes are doing! ☆



Above and below: Michal Stein's teen class learn to make and braid challah.



Students in Morah Batya's Israel Enrichment Class make falafel.



2010 HOLIDAY FAMILY PORTRAITS

Professional photos taken of your family, children or friends.
Pets are welcome too!

When: Wednesday, November 3 5:00 – 8:00 PM
 Sunday, November 7 12:30 – 4:30 PM
Where: Beth Sholom Community Center

Walk-ins welcome as time permits.
Payment is due at the photo session.

Choose pictures or cards or get a combination of both!

PICTURE PACKAGE - \$30

Includes: One 8 x 10, Two 5 x 7, Eight Wallet Size Photos

GREETING CARDS - \$35

Includes: 30 greeting cards with picture and choice of holiday greeting (Happy Chanukah, Happy Holidays or Season's Greetings)

Purchase 60 cards and mix/match two greetings

Personalize your cards, up to three lines for \$5 extra

COMBINATION - \$55

Includes: Picture Package plus 30 Greeting Cards

Pictures and cards will be available on November 21, in time to send for Chanukah!

To schedule an appointment, please call Sharon (301-865-9592).

Sponsored by National Council of Jewish Women,
Frederick Section





New Tree of Life

In honor of
Irving Sowbel

In honor of
Betty Oakes

by Lynda Sowbel & Betsy Van Ness

Beth Goldstein
Ph.D. - University of Texas
July 2009

by Marianne & Marty Erlichman

Juliana Jolie Lynch
Bat Mitzvah, Oct. 23, 2010
Love, Mom & Dad

Joyce Kimmelman

by Alison & Jack Lynch



Torah for Toddlers

A program for 2- to 4-year olds

Jewish stories, songs, snacks and activities

One Sunday a month from 10 - 11 a.m. in the
nursery room (across from the office)

Registration fee: \$50 (form on website)

2010/2011 dates:

November 14, December 12, January 9, February 13,
March 13, April 10, May 8

IF YOU ARE INTERESTED, PLEASE
REGISTER BY NOV. 15. OTHERWISE,
THE PROGRAM MAY BE CANCELED.

Eye To Eye
Family Eye Care
Tricare Network provider
Ask about our Military Discounts
Dr. Beverly Chado
Dr. Steven Chado
Optometrists
2060 Yellow Springs Road, Frederick, Maryland 21702
301.695.8771
Across from gate on Yellow Springs Road in
the Bloom Shopping Center
www.eyetoeyedr.com

BG13309DE



by Carol Blum
President
301-662-5021

Hello, everyone! We, along with NCJW, Hadassah and Kol Ami had a successful membership Ice Cream Social.

The new gift shop crew have worked out a schedule and as I write this, we are up and running again. We still need 1 or 2 people who are willing to purchase merchandise, as needed. Please call me if you can help.

Our November 21st fundraiser is well under way in the capable hands of Andrea Eyler. See page 10 of this Bulletin for the details. We'll need help to set up, clean up, sitting at the door. Again, please call me to volunteer.

Our next Board meeting will be Monday, Nov. 8, 2010 at 10 a.m. at the Community Center. Everyone is welcome.

A special get-well to Marion Zebovitz.

Thanks again for your support. ☆



National Council of Jewish Women
Frederick Section

A FAITH IN THE FUTURE
A BELIEF IN ACTION

by Marcy Taylor, President

So much to report, so little space....

At the time of writing this article, the NCJW Frederick Section team of nine walkers raised nearly \$1500 for the Alzheimer's Memory Walk. Way to go team!

Our next general meeting will be at Beth Sholom on Tues., Nov. 2 at 7 p.m.

Join NCJW Frederick Section on Nov. 7, from 10–11 a.m. for a tasting tour of *Lebherz Oil & Vinegar Emporium* in downtown Frederick. Sample over 40 different varieties of olive oil and vinegar while the owner discusses oil and vinegar pairings and shares other interesting information. The cost is \$10 (cash only please) but if you buy anything, \$5 will be credited to your purchase. Questions? Please call Diane at 301-831-8880 or e-mail: NCJWFrederick@hotmail.com.

NCJW Frederick Section will join Interfaith on Sun., Nov. 14, for the seventh annual Interfaith Candlelight Prayer Walk through the streets of Frederick. This is the first day of National Hunger and Homelessness Awareness Week and is designated as a *Community Day of Prayer for the Hungry and Homeless*. NCJW will be offering a prayer along the Prayer Walk. This lovely event begins at 6:30 p.m., starting outside the Frederick Community Action Agency at the corner of S. Market Street and All Saints Street.

NCJW Frederick Section will be preparing and serving dinner at the Soup Kitchen on Sunday, Nov. 28. If you are interested in helping with or donating to this project, please call Marcy at 301-694-8212 or e-mail: mta2003604@aol.com.

We kicked off our Adopt-a-Family program last month and there are still some dreidels and snowflakes available. The Dreidel family donations must be delivered to the Beth Sholom Community Center no later than 10 a.m. on Sun., Nov. 14 (we have been requested to deliver our unwrapped donations to Baltimore on Nov. 14 so they can be distributed in time for Chanukah). We will host a gift-wrapping "Mitzvot and Merlot" evening in December to wrap the Snowflake family gifts; keep an eye out for details.

Sharon Nicholas is conducting our annual holiday portraits and greeting cards fundraiser. Appointments are still available for Wednesday November 3. Please call Sharon and make your appointment today!

For more information on NCJW Frederick Section, please check out our web site www.ncjwfrederick.org or contact any NCJW Board Member. ☆

Beth Sholom Early Childhood Center

T/TH Bears Affairs

By Ellen Berkowitz and Sharon
Nicholas



The year has started off famously for the Teddy Bears. Many of them are returning to Beth Sholom from the 2-year-old programs. There has been no crying because they are already comfortable here, and know they are loved. Thank you to Miss Carol, Miss Heidi and Miss Sharon for getting them warmed up for us!

With only two months into school, the T/Th Teddy Bears have already done so much. We talked about bears and teddy bears and all of Jewish holidays. We talked about Yom Kippur and asked what they were sorry for. We got many answers; for example, one child said he was sorry for hitting his sibling. An interesting response was from a little boy who crossed his arms and exclaimed he has "done nothing."

We ate in our Sukkah and marched the halls with our flags for Simchat Torah. In October we talked about pairs, Noah's Ark, fall and farms. By the time you read this, we will have taken our field trip to the Pumpkin Patch—always a favorite for both the kids and the adults.

It's going to be a great year! ☆

OFFICE VOLUNTEERS WANTED

We are looking for volunteers for the office, to perform clerical functions on a regular basis: answering phones, prepare mailings, filing, etc.

If you are interested, please call or email Pauline.



ONE-STOP HOLIDAY SHOPPING!

Beth Sholom Community Center
1011 North Market Street
Frederick, MD

Sunday November 14, 2010
9:30 AM – 1 PM

**Come to Beth Sholom's
one-stop Holiday Shopping
bazaar! Proceeds benefit Beth
Sholom's Early Childhood
Center and Religious School**

Featuring:

- Beth Sholom gift shop
- Tastefully Simple – Kosher and other food products
- Pampered Chef – Kitchen tools and more
- Mary Kay and Motives Cosmetics
- Longaberger Baskets
- Creative Memories Scrapbooking
- Jewelry
 - ⇒ GMC Designs Hand Crafted Jewelry
 - ⇒ Turtle Jewelry
 - ⇒ Silpada
 - ⇒ Lia Sophia
- Crafts
 - ⇒ Blankets
 - ⇒ Handcrafted jewelry
 - ⇒ Knit hats, scarves, earwarmers, etc

And much more ...

Most items are in stock. Delivery of items that need to be ordered will be arranged with the consultant. For more information, contact Sharon at smabec@comcast.net



For the whole family!

**Beth Sholom
Congregation
&
Shoresh
present**



**Dreidel
games**



**Lots of prizes
&
Give-a-ways**

Not your Bubbie's
Chanukah Party

**Sunday, December 5th
10:00 AM-12:00 PM
at Beth Sholom Community Center
\$3/child**



**Fabulous
Magic Show**



**Hot
Pretzels**



Latkes



**Bring a \$3 or
less wrapped
present to join
in the grab bag
(please mark with a
"B" for boy or "G"
for girl)**



Doughnuts

RSVP

**to Beth Sholom
(301) 663-3437
bethsholomfrederick@yahoo.com**

or

**to Shoresh
(410) 358-8571
shoresh@shoresh.com**



Baltimore Ravens visit Camp Shoresh!

DATES

camp shoresh 2011

Meet, Greet, & Eat: Sunday, June 12, 2011
 FIRST SESSION: Monday, June 27 – Saturday Night, July 16, 2011
 SECOND SESSION: Monday, July 18 – Saturday Night, August 6, 2011
 Closing Ceremonies: Sunday, August 7, 2011 – 2:00-3:30
 NO CAMP: Monday, July 4 (Tisha B'Av)
 Friday, July 15 (Frederick Shabbaton)
 There will be camp for Little & Junior Shoresh on July 15th

special events

For Grades 2–10
 Thursday, June 30: Hershey Park
 Wednesday, July 6: Late Stay Concert,
 Boys Overnight, CIT Trip, & Picture Day
 Fri. Night – Sat. Night, July 8-9: CIT Shabbaton in Baltimore
 Monday, July 11: Little & Junior Shoresh Trip
 Tuesday, July 12: Girls Overnight
 Fri. Night – Sat. Night, July 15-16: Frederick Shabbaton
 Thursday, July 21: Kings Dominion
 Tuesday, July 26: Little & Junior Shoresh Trip
 Wednesday, July 27: CIT Trip
 Friday – Sat. Night, August 5-6: Baltimore Shabbaton

FEES

Junior Shoresh: \$735/session 1 - \$735/session 2
 (Early-bird by 1/17/11*: \$50 off per session)
 Shoresh: \$865/session 1 - \$865/session 2
 (Early-bird by 1/17/11*: \$50 off per session)
 C.I.T. Program: \$965/session 1 - \$965/session 2
 (Early-bird by 1/17/11*: \$50 off per session)
 *Early Bird applies to the first 75 families

Transportation: \$210/session 1 - \$210/session 2
 Frederick Transportation: \$75 session 1/ \$75 session 2

Sibling Discount: First child pays full tuition; each additional child receives \$35 off per session

For questions, please contact the Shoresh office at:

(410) 358-8571

Email: shoresh@shoresh.com

www.Shoresh.com





The Jewish Home: Finding Judaism in Every Room of the House

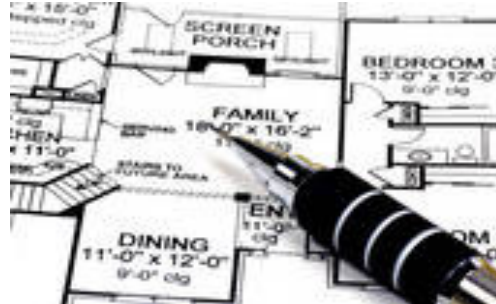

- Part #1 Wednesday, October 20th ~~KITCHEN - KOSHER KURRICULUM~~ (completed)
- Part #2 Wednesday, November 17th ~~DINING ROOM - SHABBOS~~
- Part #3 Wednesday, December 15th ~~BEDROOM - FAMILY PURITY~~

All classes will be taught by Rabbi T
and will take place at 7:30 PM at Beth Sholom Community Center
There is NO charge for these classes



November 21, 2010

Check out the deals Beth Sholom Sisterhood has for you at our

FAB PURSE PARTY!

(faux and real)

TICKETS

\$5 in advance

\$8 at the door

One student may enter free with a paying adult.

All friends welcome. Great Holiday gifts!

Munchies served



Your ticket enters you in "Purse" door prize drawings as well as access to food and drink!

- 12:30 p.m. - Doors Open
- 12:30 - 1 p.m. - Check out the purses, eat some food, visit with friends
- 1 - 2 p.m. - Silent Auction
- 2 p.m. Prompt! - Purses disbursed

Tickets available at the Beth Sholom Community Center office, 1011 N. Market St., Frederick
301-663-3437

For information call Andrea Eyler at 301-371-9457.

MAKE A DIFFERENCE

HELP THOSE IN NEED HAVE A HAPPY HOLIDAY SEASON

Each holiday season, National Council of Jewish Women (NCJW) Frederick Section "adopts" a Jewish family a.k.a. the Dreidels) and a non-Jewish family (a.k.a. the Snowflakes) in need and reaches out to the community to purchase gifts so these families can have a joyful holiday season.

Our families for this year....

The Dreidel family lives in Baltimore and has 6 children.



15 year old girl
- anything to do with sports
- books

7 year old girl
- crafts
- books

2 year old girl
- toys
- dolls

14 year old boy
- anything to do with sports
- books

5 year old twin boys
- games

The family would also appreciate gift cards from Sports Authority, Barnes & Noble, Borders, Target and Walmart.



The Snowflake family is a local Frederick family with 5 children.



8 month old boy
- pants - 12-24 mos
- shirts - 12-14 mos
- shoes - size 5 babies
- baby toys

6 year old boy
- pants - size 8
- shirts - size 8
- shoes - size 3 kids
- skateboard
- games

8 year old girl
- pants - size 10
- shirts - size 12
- shoes - size 7 1/2 womens
- crafts
- games

12 year old girl
- pants - size 8 womens
- shirts - M-L womens
- shoes - size 10 womens
- games
- crafts

13 year old girl
- pants - size 13 womens
- shirts - XL womens
- shoes - size 9 womens
- skateboard
- games
- craft

The children would also like a Nintendo DS system with games. Cash donations towards this purchase would be appreciated. (See instructions below for cash donations) and NCJW will purchase.



In order to distribute the gifts fairly and reduce duplication, we will have "snowflakes" and "dreidels" each with a requested gift written on it. The "snowflakes" and "dreidels" will be available in the Community Center lobby starting on October 3. Please take as many as you want, but PLEASE make sure to purchase those items.



If you can't make it to the Community Center to pick up a snowflake or dreidel, please call the Community Center and one can be reserved for you.

Bins will be available in the Community Center Lobby to drop off your gifts beginning on Oct 3.

Please bring your gifts for the Dreidel Family BY 10AM ON NOV 14 for the Dreidels

and by Dec 14 for the Snowflakes.



If you would prefer to make a donation (and we will buy gifts), make checks payable to NCJW and mail to: Marcy Taylor, 608 Bushytail Drive, Frederick, MD 21703.

Please indicate to which family you would like the money to go.

For questions, call Diane at 301-831-8880 or Margie at 301-696-8679.

Join us for
Shabbat.



Please join us with your friends and family on
Friday, December 3, 2010
at 6:30 p.m.

for a Shabbat service and community dinner.
We will celebrate Chanukah!



Beth Sholom Community Center
1011 N. Market Street
Frederick, MD 21701
301-663-3437

Cost: \$12 per adult
\$8 per child age 3-12
Family maximum \$48

Please RSVP to bethsholomfrederick@yahoo.com
or 301-663-3437 by Wednesday, Nov. 24.
then mail in or drop off your payment.

Yahrzeits
CHESHVAN/KISLEV 5771
NOVEMBER 2010



November 5*

Morris Linzner
 Rebecca Linzner
 Charles Siegel
 Dora Silvard
 Lillian Chertoff
 Robert Routier

Samuel Elkin
 Harry Nathanson
 Solomon Simon
 Gladys Jacobson
 Helen Pearlman
 Hannah Pittleman

November 12*

David H. Cornish
 Jordon Schwartz
 Arnold Edland
 Mildred Gordon Misler
 Albert Potash
 Harry Reitman
 Joseph Goldblatt

Jonathan Abelow
 Doris Honigman
 Beatrice S. Hornstein
 Gussie Becker
 Milton Diener
 Anthony Trojecki
 Beverly Bondy Rose

November 19*

John B. Cramer
 Jacob Pittleman
 Max Shapiro
 Max Wolberg
 Herman Blank
 Clara Blatt
 Freda Kaufman
 Saul Kochonin
 Lena B. Pendek
 Lillian Epstein

George Rosen
 Martin Rude
 Martin Miller
 Louis J. Prensky
 Samuel Potash
 Sara Trabish
 Sylvan Harris Better
 Beatrice Miller
 Louis Kosman
 Deane Levine

November 26*

Bess Pincus
 Elizabeth Reitman
 Bernard Zavos
 Joseph Elfman
 Saul Miller
 Israel Ruck
 David Blatt
 Doris Goldstein

Viktor Levy
 Channah Miller
 Peshe Leah Miller
 Rachel Pia Miller
 Geta Elkon
 Bernard Mlavsky
 Andrew David Nisenfeld

DONATIONS



Beth Sholom gratefully acknowledges the following donations:

Aliyahs and Honors

Cindi Diamondstone for High Holy Day honor

Building Fund

Barbara Fromer for the Yahrzeit of Philip Fromer and Alan Hillman
 Regina Kaiktsian

Early Childhood Center

Joyce & Milt Gordon for the speedy recovery of Leah Reitman
 Shirley Neufeld in honor of Janis Sclar's special birthday
 Shirley Neufeld for the speedy recovery of Leah Reitman

Education Fund

Anne & Michael Cohen in memory of Pearle Carpel

General Fund

Phyllis & Gary Schwartz for the Yahrzeit of Jordan Schwartz
 Karen & Joe Ashwal for the Yahrzeit of Dora Silvard
 Florence and Maish Guss for the Yahrzeits of Tina Hasson and Samuel Hasson
 Donna & Coleman Clarke for the Yahrzeit of Mordecai Clarke
 Selma Blum for the Yahrzeits of Gertrude Bernstein and Samuel Blum
 John Horowitz for the Yahrzeit of Oskar Horowitz
 Daniel Pearlman for the Yahrzeit of Helen Pearlman and Bertrand Pearlman
 Sylvia & Marvin Elfman in memory of Sidney Levine
 Fern Camann in memory of Dr. Arnold Raphaelson
 Ibbey & Howard Levine in memory of Pearle Carpel
 Regina Kaiktsian in memory of Mike Chertoff
 Rosalind & Stanley Krimins in honor of Rabbi Singerman
 Sylvia & Marvin Elfman for the Yahrzeit of Jack Dorris
 Melinda Cohen & Al Goetzl for the Yahrzeit of Sylvia Goetzl
 Signe & Leon Wetrogan for Yiskor

High Holy Day Appeal

Margie and Harvey Kurzbard

Paul & Rita Gordon Music Education Fund

Rita & Paul Gordon for the Yahrzeits of Mildred Gordon Misler and Solomon Simon

Shapiro G'Mach/Chesed Fund

Trish & David Ben-Avraham in memory of Mike Chertoff ❖

* indicates Friday on which name will be read from the Bima.

The perfect setting for your special event!



Frederick - Ft. Detrick

Present this coupon and receive **10%** off the rental fee for our elegant banquet hall. Seating and catering available for up to 120 people.

- Not valid with other offers -

Kosher menus available upon request.

**Out of town guests?
Ask for promotion code "BSC" for discounted guest room accommodations.**

1565 Opossumtown Pike • Frederick, MD 21702
Call Reba at **(301) 696-1565**

*Who can number
the sands of the sea,
the drops of rain,
and the days of eternity?
- Ben Sira 1:2*



**The Garden of Solomon
and
Resthaven Funeral Services**



Beautiful • Peaceful • Local

9501 Catoctin Mountain Highway
U. S. Route 15 North
Frederick, MD 21701

Cemetery **301-898-7177**
Funeral Home **301-898-1577**



Call 24 hours a day
for information

DAWN CRAMER STEIN

Certified Public Accountant



The CPA. Never Underestimate The Value.®

304 Delaware Road
Frederick, MD 21701-4618
dawn@dsteincpa.com

Tel: 301-663-8368
Fax: 301-663-6786
Cell: 301-964-3326



HEART FIELDS

Assisted Living & Alzheimer's Care at Frederick

1820 Latham Drive Frederick, Maryland 21701
(301) 663-8800 • (301) 663-8801 Fax



A Five Star* Quality Care Community

*Be sure to find us
at the Elder Expo
at the Five Star booth*



Family and Cosmetic Dentistry

401 W. Seventh Street • Frederick, MD 21701
Tel: 301.662.7766 • Fax: 301.662.7776
www.friederdental.com
drfrieder@yahoo.com



Office Hours By Appointment

**NEWMAN FAMILY CHIROPRACTIC
DR. IAN NEWMAN**

198 Thomas Johnson Dr., #12
Frederick, Maryland 21702
(301) 696-8888, Fax: (301) 696-9618
1190 Mount Aetna Road
Hagerstown, MD 21740
(301) 791-5900

MJ Minton
ASSOCIATE BROKER, ECOBROKER®



TURNING POINT
REAL ESTATE

*Residential and Commercial
Sales and Rentals*

Special Training in Energy Efficiency
Affecting Today's Real Estate Transaction



CELL 240.674.3374
OFFICE 301.831.8232
www.mjminton.net



**SUNSHINE MANAGEMENT
CORPORATION**

Nelson S. Zahler

President
Broker

Phone: (301) 663-8383 ext: 202
Toll Free: 1-800-663-4990
Fax: (301) 663-0070
nelsonz@sunshinemanagement.net

Ambers Professional Center
178 Thomas Johnson Drive, Ste. 201
Frederick, MD 21702-4334
www.sunshinemanagement.net



Mark S. Hoffrichter, D.D.S.
Oral & Maxillofacial Surgery

Mark S. Hoffrichter, DDS

Centerpark Medical Center

604 Solarex Court, Suite 207
Frederick, MD 21703
301 695-5755

www.HoffrichterDDS.com



David J. Levine, D.P.M., C. Ped.

Podiatrist & Podorthist
www.Levinefeet.com

63 Thomas Johnson Drive
Suite C
Frederick, MD 21702

301-696-0818
Fax 301-696-8872

PODIATRY • FOOT SURGERY • SPORTS MEDICINE



Speaking of death...
no one does because
it can be difficult.

Since our incorporation in 1999, we have been holding the hands of individuals like yourself and helping them to prepare for the unspeakable. Our trained counselors are here to ease your situation, whether it's pre-planning or the sudden loss of a loved one. We will advise you on burial methods and locations, costs and payment plans, funeral practices and traditions, and memorial choices.

We are skilled in the sacred rituals of all branches of the Jewish faith, and have experienced counselors here to assist you. Individual and family sites are available, and to date, 20 congregations have reserved sections for their congregants.

To schedule an appointment, contact our Help Line today at 301.428.3000, or visit www.gardenofremembrance.org.

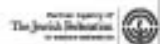

10 Years of Caring Service, Eternal Peace and Beauty



SEYMOUR B. STERN & ASSOCIATES, P.A.

SEYMOUR B. STERN
ATTORNEY AT LAW

127 WEST PATRICK STREET
FREDERICK, MARYLAND 21701

TEL: (301) 663-5335 x110
FAX: (301) 663-8929
E-MAIL: SSTERN@ST-LAW.COM



BETH SHOLOM CONGREGATION
 1011 North Market Street • Frederick, MD 21701

Non-Profit Organization
 U. S. Postage
PAID
 Frederick, MD
 21701
 Permit No. 162

RETURN SERVICE REQUESTED

November 2010 24 Cheshvan 5771 - 23 Kislev 5771

Sunday	Monday	Tuesday	Wednesday	Thursday	Friday	Saturday
	1 24 CHESHVAN Shoresh Bing	2 25 CHESHVAN NO SCHOOL	3 26 CHESHVAN	4 27 CHESHVAN 8 a Minyar 11 a Brunch Bunc	5 28 CHESHVAN 5:47 6:30 p Service Bar Mitzvah of Max Canto	6 29 CHESHVAN Toldot 9:30a Service Bar Mitzvah o Max Canto 10:30a Tot Shabb:
7 30 CHESHVAN Rosh Chodesh Kisle - Day 1 9:30a Religious Scho 9:30a Bat Mitzvah c Adi Singerma Bingo	8 1 KISLEV Rosh Chodesh Kisle - Day 2 10a Sisterhood Meetir Bingo	9 2 KISLEV	10 3 KISLEV	11 4 KISLEV 8 a Minyar 11 a Brunch Bunc	12 5 KISLEV 4:40 6:30 p Service	13 6 KISLEV Vayetzr 9:30a Service
14 7 KISLEV 9:30a Minyar 9:30a Religious Scho 9:30 -1Chanukat Bazaar Bingo	15 8 KISLEV Shoresh Bing	16 9 KISLEV	17 10 KISLEV 7 p Board of Trustee Meeting 7:30p Shoresh Adul Class	18 11 KISLEV 8 Minyar 11 a Brunch Bunc	19 12 KISLEV 4:35 6:30 p Service	20 13 KISLEV Vayishlact 9:30a Service
21 14 KISLEV 9:30a Minyar 9:30a Religious Scho 9:30a Brunch anc Learn 10:30 a Mach Meeting 12:30p Sisterhood Pur Party Bingo	22 15 KISLEV Bingo	23 16 KISLEV	24 17 KISLEV NO SCHOOL	25 18 KISLEV Thanksgiving Da 8 a Minyar NO SCHOOL	26 19 KISLEV 4:31 NO SCHOOL 6:30p Service	27 20 KISLEV Vayeshe 9:30a Service
28 21 KISLEV 9:30a Minyar NO SCHOOL Bingo	29 22 KISLEV Bingo	30 23 KISLEV				

Please check the website
 for calendar updates
www.bethsholomfrederick.org